

# CLARIDGE SERIES 4 - FACTORY BUILT MARKER/TACK UNITS TRIM SECTION DETAILS

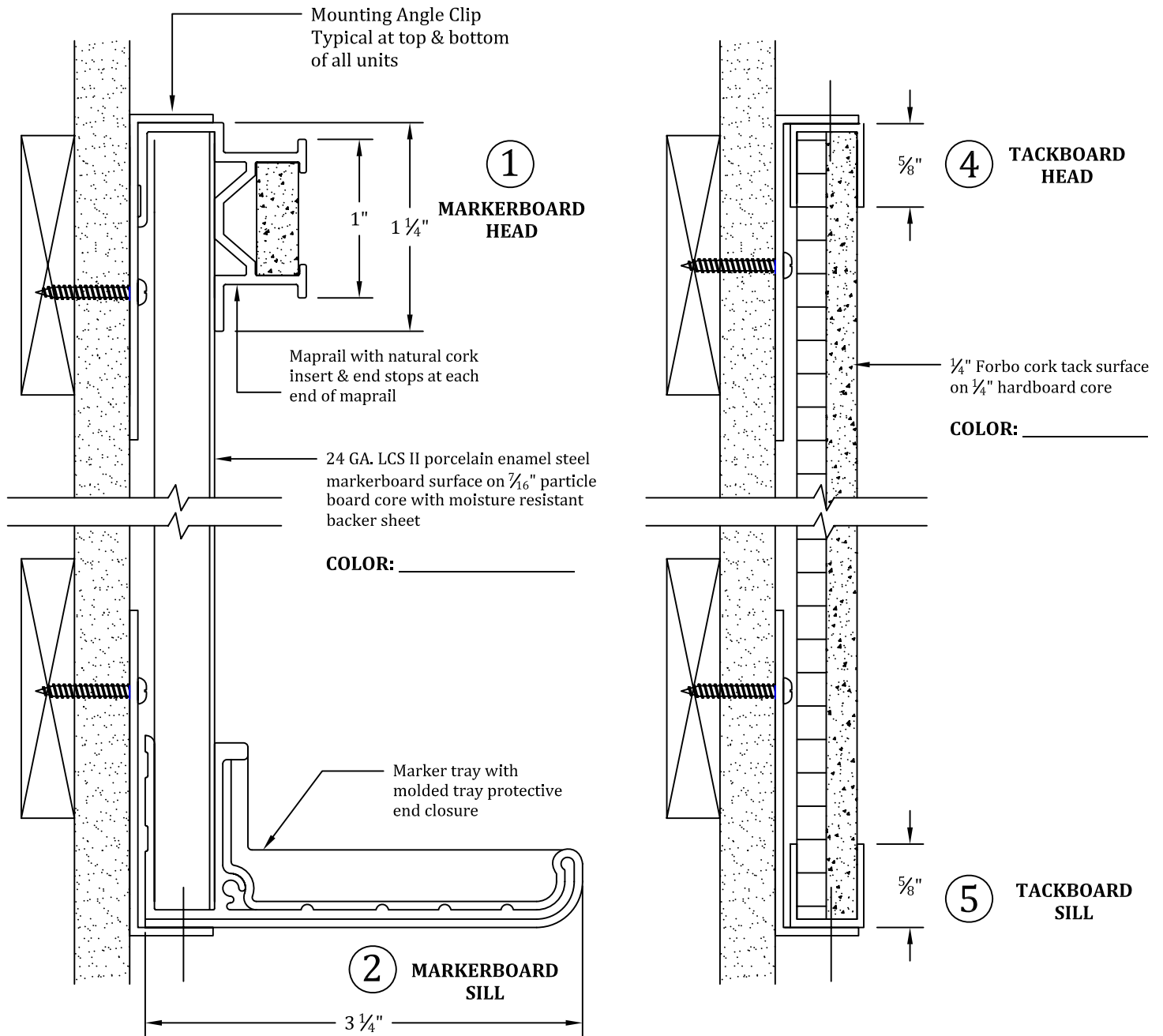

SCALE: NOT TO SCALE

All aluminum trim to be minimum .062" thickness

Section:		Project: Location: Architect: Contractor:	Color Selection		
P.B.S. Supply Co. 7013 South 216th Street Kent, WA 98032 Phone: (253) 395-5550 Fax: (253) 395-5575 www.pbssupply.com			Markerboard: _____ Tackboard: _____ Alum. Trim: Clear Satin Anodized		
File:	Date:		Drw #	By:	

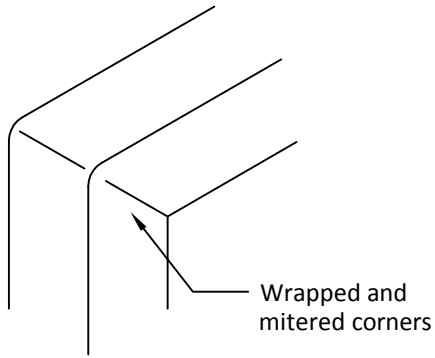

**CORNER DETAIL**

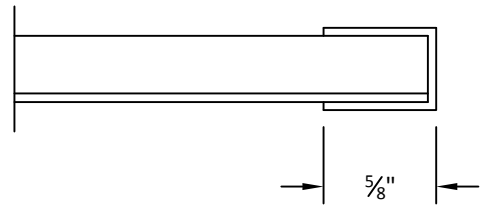

3

**CLEAR SATIN ANODIZED ALUMINUM TRIM AT PERIMETER**

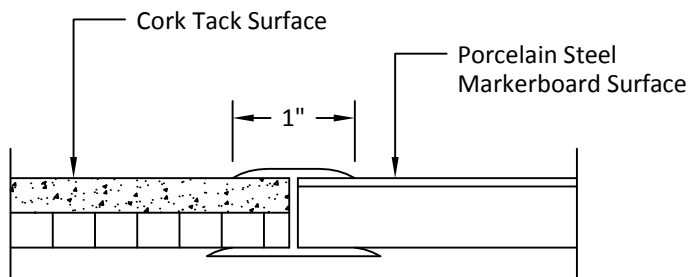

**SATIN ANODIZED FLAT H-BAR DIVIDER JOINTS FOR BETWEEN MARKER / TACK BOARDS**

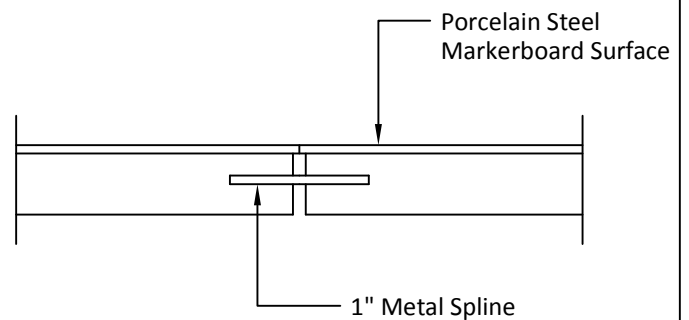

**OPTIONAL SPLINED JOINTS BETWEEN MARKERBOARD PANELS**

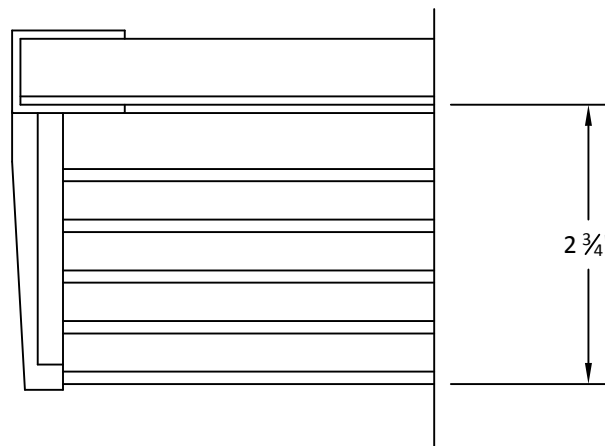

**SAFETY FEATURE JAMB DETAIL WITH MARKERTRAY AND PROTECTIVE END CLOSURE**

